

THE SPEEDFLASH®

1 General Characteristics

The revolutionary SpeedFlash® is designed to improve the speed and ease of solar installations on slate roofs. Ensuring a waterproof solution when fitting roofing slates around a roof bracket when installing solar photovoltaic, or other panels.

SpeedFlash® is very easy to install and enables you to do a high-quality job and leave the roof tidy, reliable and weatherproof.

The SpeedFlash® streamlines solar installations on slate roofs with a quick, no-drill through slate method that preserves roof integrity.

Ideal for 18"+ slates, it minimizes the need for slate removal.



Video link and Installation Guide

[SpeedFlash Info - Genius Roof Solutions](#)

[SpeedFlash Instruction Booklet - Genius Roof Solutions](#)

2 SpeedFlash® system kit content

Product Code: **SPF005**

Item	Country of Origin	Commodity Code	Net Weight (Kg)	Main Material
SpeedFlash®	UK	39259010	0.2455	Polypropylene (92%)
Foam	UK	3921131090	0.0063	Fireflex T30
Shim (2off)	UK	44121000	0.0273	Plywood
Spring Support	UK	73209090	0.0035	316 grade marine Stainless Steel
SpeedFlash® Shield	UK	7226997093	0.236	1.2mm Galvanised Steel

3 Good to know

SpeedFlash® is compatible with 18" to 24" slates. SpeedFlash® can be used on 16" slates however due to the need to maintain a 3" head-lap, the working area will be reduced. This reduces the compatibility with certain brackets. SpeedFlash® is not compatible with Pantile (wide plate) brackets, due to the width of the entry point into the SpeedFlash®. The working area will allow for brackets with a maximum fixing plate height of approximately 80mm.

Attaching the cap: Start at the bottom of the cap, attach the lip on to the base of the SpeedFlash. When lip is attached, proceed to push down cap onto base, allowing the 4 clasps to make contact and clip into place.

Spring Support made from marine grade 316 Stainless Steel.

Plastic can be brittle in cold weather, do not attempt to bend during installation.

Use appropriate safety PPE. Foam must be used to seal the hood.



Genius Roof Solutions 120 Clydesdale Place, Moss Side Industrial Estate, Leyland, PR26 7QS

Email: sales@geniusroofsolutions.com

Tel: 01257 793113

VAT: 818 0722 37

EORI: GB818072237000

4 SpeedFlash® Drawing

SpeedFlash® Cap

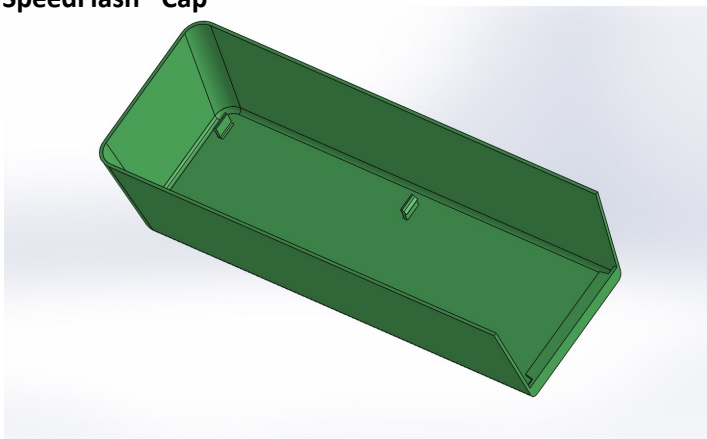

SpeedFlash® Base

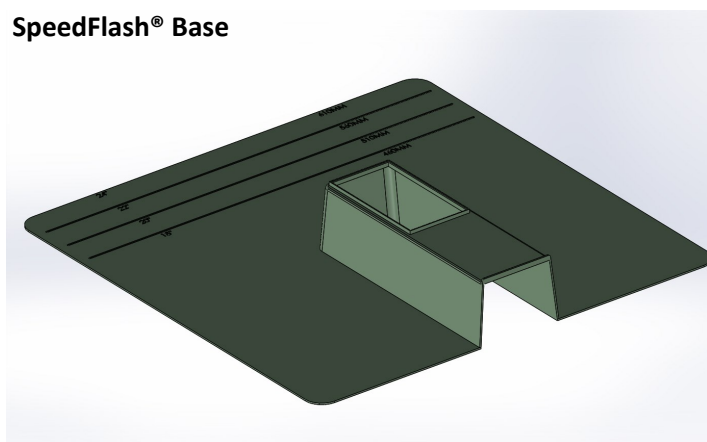

SpeedFlash® Base and Cap Combined

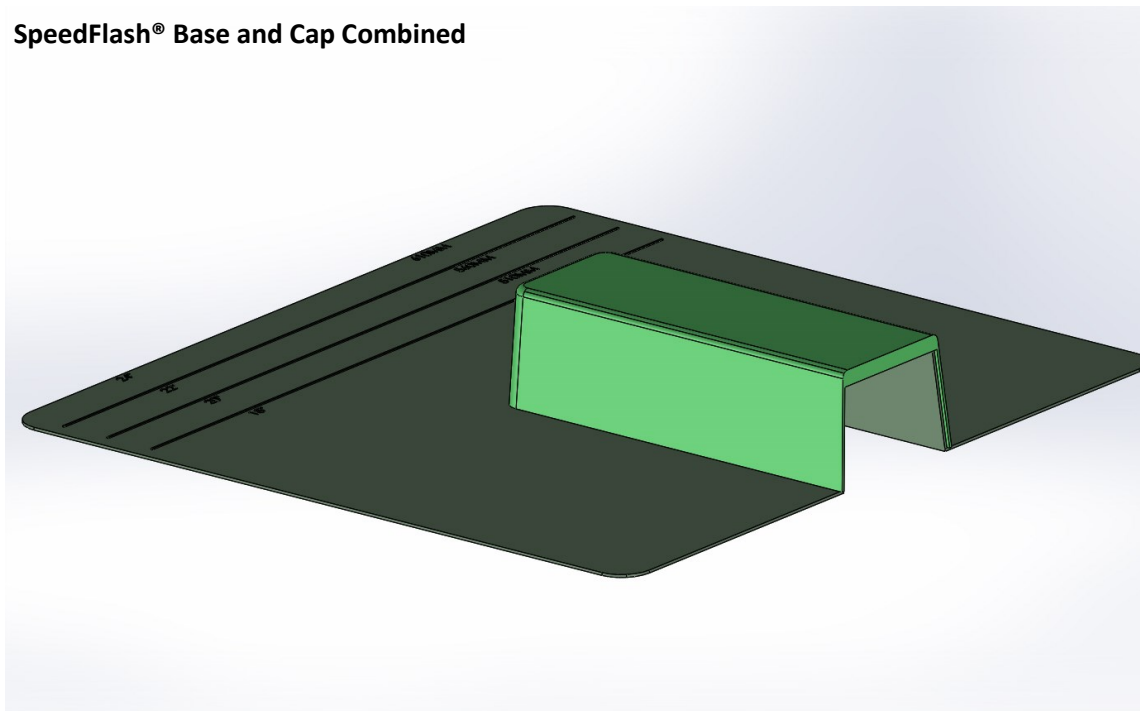

Genius Roof Solutions 120 Clydesdale Place, Moss Side Industrial Estate, Leyland, PR26 7QS

Email: sales@geniusroofsolutions.com

Tel: 01257 793113

VAT: 818 0722 37

EORI: GB818072237000

5 Technical specification: SpeedFlash® cap & base

GRS Product Code: SPF003 & SPF002

SpeedFlash®

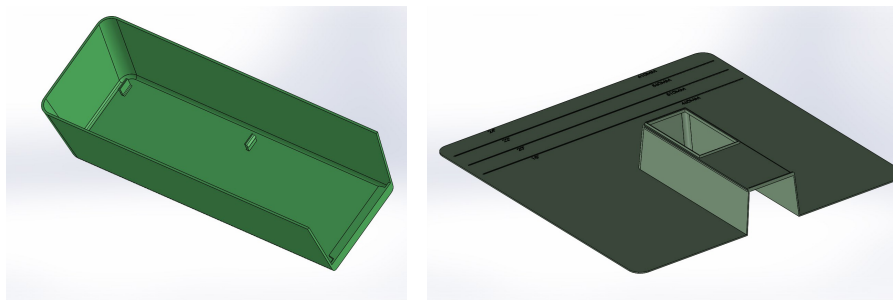

Dimensions

365 x 365 x 55mm

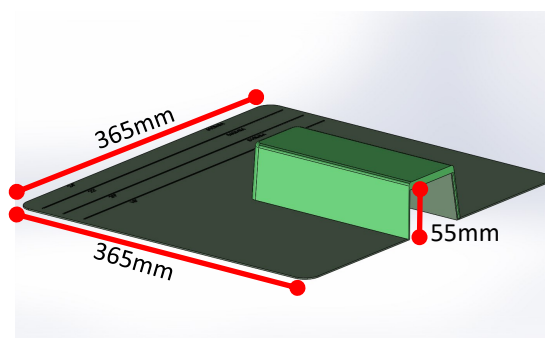

Net Weight (Kg)

0.2455

Purpose

Waterproof solution to fitting slates around a roof bracket when installing solar photovoltaic, or other panels without the need for drilling.

Supplier

Dee Bee Performance Plastics Ltd

Material

Polypropylene with added carbon black, flame retardant and UV stabiliser.

Standards and

BS 5534

Building Regulations

Slating and tiling for pitched roofs and vertical cladding code of practice.

Testing

Pending

Genius Roof Solutions 120 Clydesdale Place, Moss Side Industrial Estate, Leyland, PR26 7QS

Email: sales@geniusroofsolutions.com

Tel: 01257 793113

VAT: 818 0722 37

EORI: GB818072237000

6 Technical specification: Foam

GRS Product Code: SFFOAM001

Foam



Dimensions

Widest part 80mm narrowing to 70mm at bottom with depth of 40mm

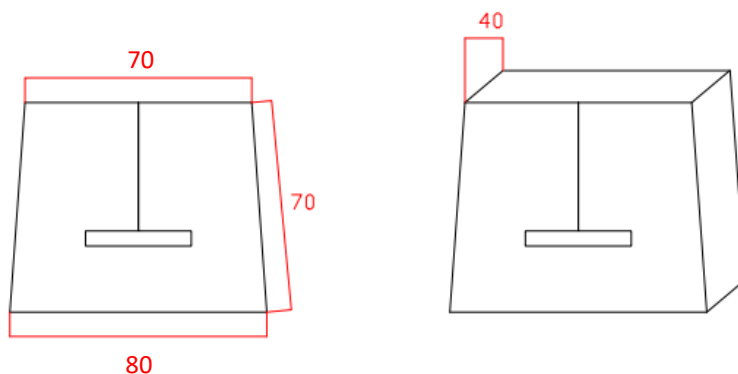

Net Weight (Kg)

0.063kg

Purpose

The foam is essential to seal the hood. The foam is designed with snow in mind, it is there to stop wind taking light snow into the roof.

Supplier

Recticel Flexible Foams

Material

FIREFLEX® T 30N is a polyether based foam with excellent fire resistant properties and acoustic performance.

Specification

Flexible PU foam targeting different noise reduction coefficient (NRC) ratings. It combines excellent sound absorption properties with good heat, humidity and chemical resistance.

Property	Unit	Method	Value
Net density	Kg/m ³	ISO 845	26-29
Compression Resistance 40%	kPa	ISO 3386	2.6-3.8
Compression Set (50% compression)	%	ISO 1856/A	≤ 9
Cell diameter (Visiocell)	Micron	RECTICEL/T.013.4	740-1080
Flammability (thickness at 13mm—before and after ageing)	Class	UL 94	HF1
TYPICAL VALUES			
Property	Unit	Method	Value
Elongation at break	%	ISO 1798	240
Tensile Strength	kPa	ISO 1798	110

Standards and

Building Regulations

In combination with PU facings, it meets flammability ratings such as FMVSS-302 and UL94 HF-1.

Testing

Pending

7 Technical specification: Shim GRS Product Code: SHI001

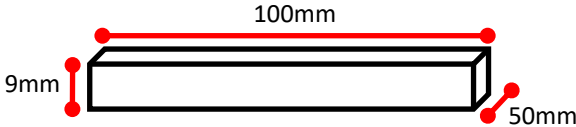
<p>Shim</p>	
<p>Dimensions</p>	<p>100 x 500 x 9mm</p> 
<p>Net Weight (Kg)</p>	<p>0.0273</p>
<p>Purpose</p>	<p>The shims are used to lift the roof anchor/bracket away from the slate underneath the bracket.</p>
<p>Supplier</p>	<p>ASC Timber Supplies</p>
<p>Material</p>	<p>Plywood/Ext Glue DOP-GD-E004 EN 13986 EN636-2S E1 FSC 100% Wood from well managed forests.</p>

8 Technical specification: SpeedFlash® Spring Support **GRS Product Code: SPF001**

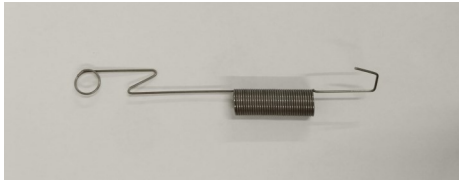
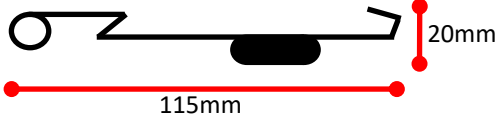
SpeedFlash® support	
Dimensions	<p>115mm by 20mm</p> 
Net Weight (Kg)	0.0035
Purpose	The SpeedFlash® Spring Support is used to keep the SpeedFlash® in place.
Supplier	Protoform Springs & Pressings
Material	316 grade marine Stainless Steel
Testing	Pending

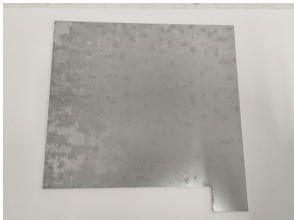
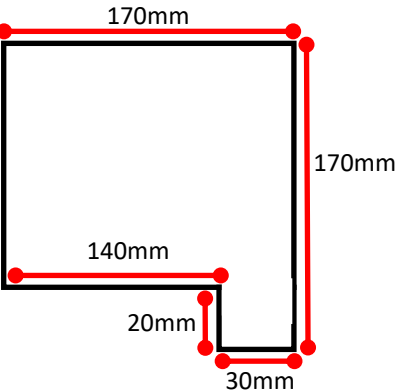
9	Technical specification: SpeedFlash® Shield	GRS Product Code: SPF008
SpeedFlash® Shield		
Dimensions	<p>Overall size: 170mm by 170mm</p> 	
Net Weight (Kg)	0.236	
Purpose	The SpeedFlash® Shield is used to protect a specific area of the course below when cutting the top slate.	
Supplier	AK Stainless Ltd	
Material	1.2mm galvanised steel.	
Specification	<p>The SpeedFlash® Shield does not remain on the roof - the shield is used as a tool. It is used to protect a specific area of the course below when cutting the top slate(s).</p> <p>The SpeedFlash® Shield is not a single use item, it can be used multiple times.</p>	