

DEKS Fast Flash Installation Guide

deks.co.uk/fastflash



This product is designed for the professional roofer. We strongly recommend you engage an experienced fitter, ensuring you receive quality workmanship and Performance from your flashing.

Accessories and tools recommended

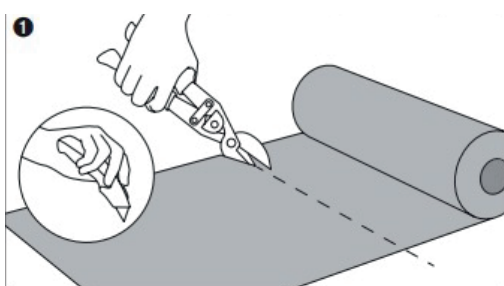

1 Cutting Fast Flash

Tools required: Snips, Scissors or a good trimming Knife, Tape Measure

2 Preparation

Ensure surface is clean and dust free. Surfaces can be primed with Flash Seal or use a spare cut section of Fast Flash to dab the area to remove debris with the sticky butyl backing. Ensure the surface is completely dry. Fast Flash will not adhere to a wet surface.

Tip If you need to apply to a wet surface, you can use Fast Flash / Perform Adhesive supplied separately if required.

Tip Butyl based products will not stick in the wet or on a dusty surface.

3 Positioning Fast Flash

Fast Flash has a pre-split removable backing. To aid installation, it is best to remove these in stages where and when you are applying the product to the surface. There is no need to peel the backing off fully before installation. In areas of potential wind blown dust, do not remove the surface protection until the risk of dust has diminished.

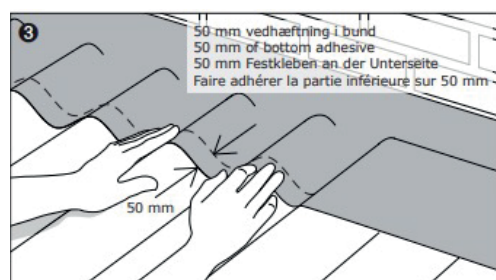

4 Adhering Fast Flash

The butyl backing of Fast Flash will adhere to almost all roof surfaces.

It is always advisable and good practice to ensure all backing film is removed for total adhesion. On profile tiles ensure 50 mm is fully bonded and allow Fast Flash to taper up to the top of the tile where it is bonded to the wall. On a plain tile, you can fully adhere all surfaces and dress into the corner.

Tip Flashing over brick work - The flashing is 100% butyl backed and has a large adhesion area, there is no need to use a chased-out course to bury it into a wall although Fast Flash can be installed with this method if desired. If preferred, apply a bead of Fast Flash / Perform Adhesive to provide a leading edge seal.

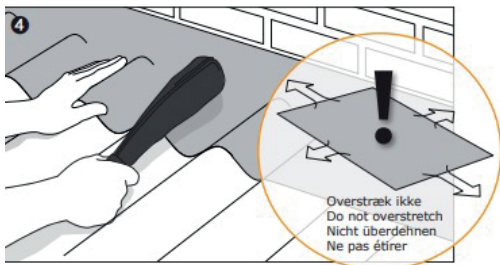

5 Dressing Fast Flash

Tools Required: DEKS Fast Flash/Perform Hammer, Soft Roller, Damp Cloth

We recommend our dedicated Hammer (supplied separately). This is a soft leather bag filled with heavy-media attached to an ergonomically designed handle. It will not damage the product when dressing unlike traditional lead dressing tools.

It is also wise to use a soft rubber type roller to apply pressure to the flashing on some profiles.

Ensure that the butyl surface has fully adhered to the tile. If there is any movement between the Fast Flash and the tile, it has not adhered. If it has not adhered check for dust or damp conditions preventing the seal. If so, use Fast Flash / Perform Adhesive or Flash Seal. Reapply pressure until fully adhered. If needed, this can be aided with the use of a heat gun to increase tackiness.

Workability

Never over stretch Fast Flash. The length it stretches up to 60% and width 20%. This will be sufficient to make a perfect job on all kinds of profiles on roofs.

In normal conditions there is about a 20 minute bonding delay to surfaces. This means you can rework the area if you need to. Butyl to butyl adhesion occurs immediately.

 **Tip** When applied wipe the flashing of with a damp lint free cloth to clear any dust particles.

Flashing over brickwork, chimneys and abutments



To create a lap joint, join 2 faces of butyl together for an amazing waterproof seal, use the dressing tool or roller to flatten these for presentation purposes.

Applying Fast Flash over Fast Flash is fine. In colder weather, this can be sped up by using of a small amount of Fast Flash/Perform adhesive on the laps or by using a heat gun on the butyl adhesive.

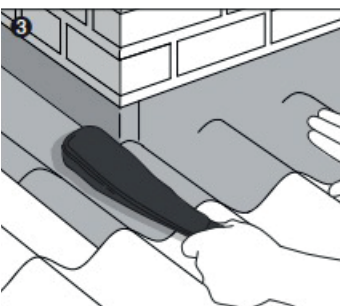
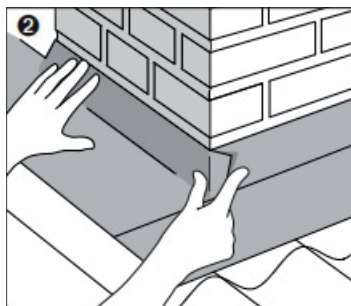

 **Tip** Only peel off backing where the product is to be applied this will avoid any unwanted bonding onto other areas.

 **Tip** There is no need to cut at less than 5 meters for expansion purposes. On runs over 5 metres, overlap by 100 mm.

Other bonding tips

 In a cold climate applying a little heat to the butyl will make it tackier and so improve the bond. You can also apply a weight to the flashing for a short period if you judge it to be required. The product is easier to press down over a larger area using a damp cloth to lessen friction.

Durability

Under BBA certification, Fast Flash has a service life in excess of 20 years.

The life span can be increased further with application of Flash Seal every 5 years after the 20 year anniversary.

Flash seal will protect the surface of Fast Flash where it is used on close proximity to, or on, Asphalt, Bitumen or Copper. If not used, rain splashes will cause surface to degrade prematurely.

